

NovoPen[®] 4

Your NovoPen[®] 4 at a glance



NovoPen[®] 4



Dose counter
Use it to see the dose you select.

Dose pointer

Pen cap

Always replace it to protect the insulin from light.

Dose button

Turn it to select your dose.
Press it down to inject your dose.

Single use needle

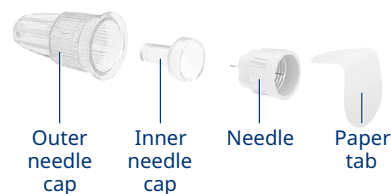

Penfill[®] cartridge

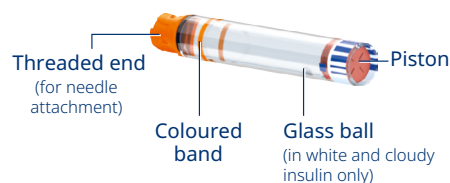

Quick **step-by-step** guide to use

INSERT PENFILL[®] CARTRIDGE AND ATTACH NEEDLE

STEP 1 Remove pen cap

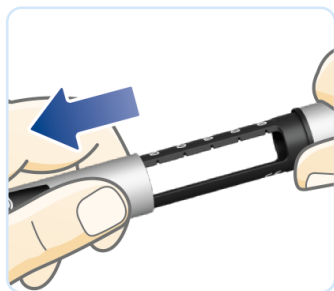

STEP 2 Twist off cartridge holder

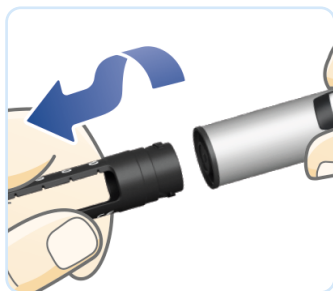

STEP 3 If the piston rod sticks out, push in until it stops

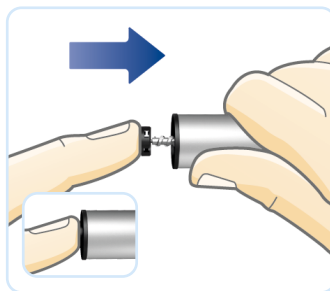

STEP 4 Insert cartridge, threaded end first



STEP 5 Twist cartridge holder back on until you hear or feel a click

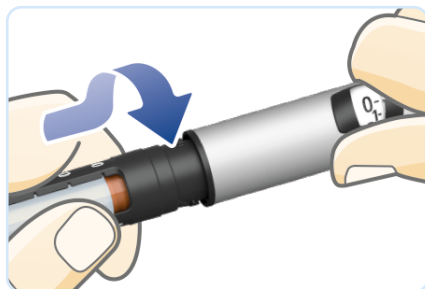

STEP 6 Remove the paper tab from a new needle and push needle straight onto pen



STEP 7 Remove outer and inner needle caps. Keep the outer cap for safe needle disposal

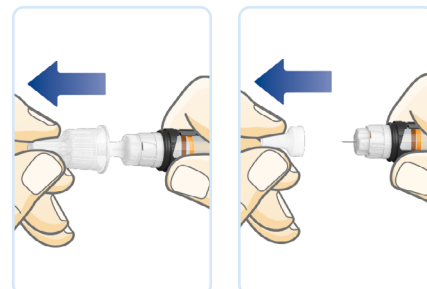

For a full explanation of how to use your NovoPen[®] 4, please read the Instructions For Use that accompany your pen. Please turn over for important safety information.



ALWAYS TEST INSULIN FLOW AFTER INSERTING A PENFILL® CARTRIDGE

STEP 1 Remove any gap between the piston rod head and the piston, and any air bubbles.

STEP 2 Pull out the dose button and select **2 units**.

STEP 3 Press the dose button until the dose counter shows '0'.

If no insulin appears OR there is a gap, repeat steps 1-3 until the pen is ready for use.

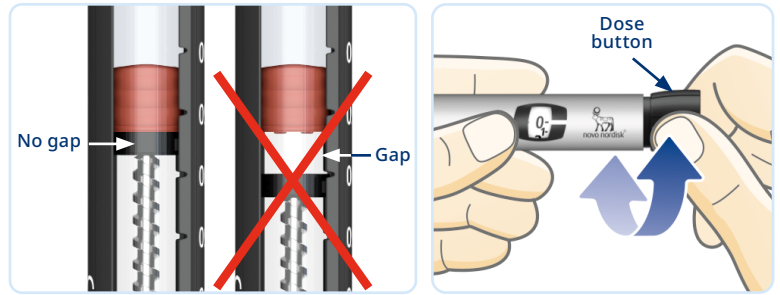

If you do not check the insulin flow you may not receive your full insulin dose.

INJECT YOUR INSULIN

STEP 1 With the dose counter at **0**, pull out the dose button and turn to select the number of units you wish to inject.



STEP 2 Insert the needle and press the dose button until the dose counter shows **0**. Count slowly to **6** before you remove the needle.

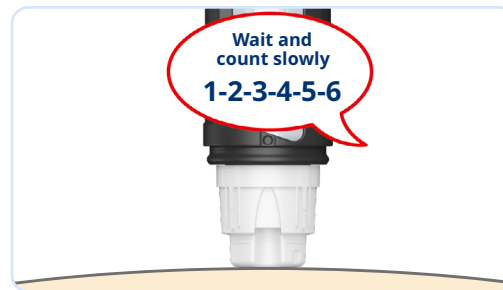

Safely remove and dispose of the needle and put the pen cap back on.

INJECTION SITES

The main injection sites are the thighs, stomach, buttocks or back of the upper arms. Ask your doctor or nurse which sites are recommended for you.

Make a mark of your recommended injection site

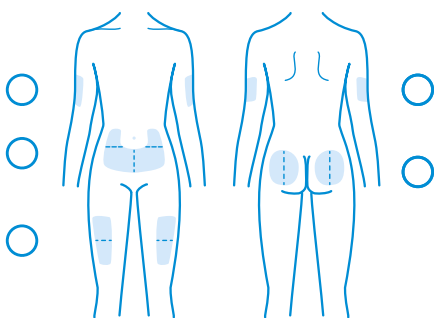

To increase comfort, make sure you choose a different place to inject for every injection.

- Divide the injection sites into halves or quarters and use a different half/quarter every week.
- In each half or quarter, rotate the place of injection clockwise by about the width of a finger from the last injection point.

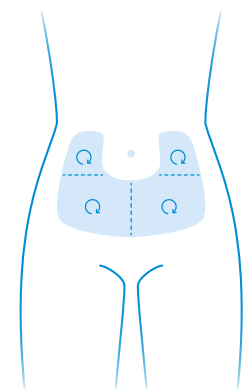

FOR FURTHER INFORMATION OR SUPPORT



Questions about how to use your pen, or technical issues? Call Novo Nordisk Medical Information – **1800 668 626**

NovoPen® 4

Novo Nordisk Pharmaceuticals Pty Ltd. Level 10, 118 Mount Street, North Sydney NSW 20260.
ABN 40 002 879 996. Novo Nordisk Medical Information (Australia) 1800 668 626. www.novonordisk.com.au.
© Registered trademark of Novo Nordisk A/S. NON00Y0146. AU24NP400006. August 2024.

